

Asking Price £340,000

Jayman
www.jayman.co.uk

Asking Price £340,000

Jayman
www.jayman.co.uk

Estate Agents



Patrick Mews
Lichfield, WS13 7UZ

Patrick Mews
Lichfield, WS13 7UZ

Patrick Mews, Lichfield, WS13 7UZ

New Price!

Jayman are pleased to market this well presented four bedroom townhouse situated within close proximity to the Lichfield city centre, all local amenities and transport links . The property in brief comprises gas central heating, double glazing, hallway, kitchen/diner, four good sized bedrooms, family bathroom, ensuite in the master bedroom and two w/c's. There is a garage included.

Hallway leading to; 19'4" x 3'11" (5.9 x 1.2)

Downstairs cupboard in hallway

Kitchen/diner 15'5" x 12'9" (4.7 x 3.9)

With a range of storage units and including fridge/freezer and washing machine

W/C 5'10" x 2'7" (1.8 x 0.8)

Stairs leading to first floor;

Bedroom 4 6'2" x 9'6" (1.9 x 2.9)

Smallest bedroom suitable for a single bed or dressing room/office

Bedroom 3

Good size single or double bedroom

W/C 8'6" x 5'6" (2.6 x 1.7)

Lounge 15'5" x 12'5" (4.7 x 3.8)

Large Lounge including a built in fireplace (fire not operational).

Stairs leading to the second floor;

Family bathroom 10'2" x 6'2" (3.1 x 1.9)

Spacious family bathroom including a separate shower and large bath, w/c and hand basin

Bedroom 2 12'9" x 8'6" (3.9 x 2.6)

Double bedroom including a fitted wardrobe

Master Bedroom 14'9" x 10'9" (4.5 x 3.3)

Large double master bedroom with two fitted wardrobes with door to ensuite

Master Bedroom Ensuite 5'2" x 5'10" (1.6 x 1.8)

Including shower, w/c and hand basin

Garage

Single garage with electric door

Rear Garden

Offers

All offers must be supported by proof of funds and / or proof of mortgage agreement in principle.

REQUIRE A MORTGAGE? Our independent advisor can compare "whole of market" to help find the best mortgage to suit your circumstances. Please call 01543 416 567 for a free mortgage quote including some deals only available through our network. **LEGAL CONVEYANCING** Jayman Conveyancing provides fast efficient low cost legal work with a no sale-no fee guarantee. Call 01543 416 567. **AGENTS DESCRIPTIONS** These details imply the opinion of the agent at the time these details were prepared and are subjective. It may be that the purchaser's opinion differs. **VIEWING ARRANGEMENTS** By appointment only with Jayman on 01543 416 567 **COUNCIL TAX** Please refer to www.voa.gov.uk for this information. **DESCRIPTIONS AND MEASUREMENTS** All measurements are approximate and some may be maximum on irregular walls. The plan shows the approximate layout of the rooms to show the inter relationship of relationship of one room to another but is not necessarily to scale. **CONSENTS** We have not had sight of any relevant building regulations, guarantees or planning consents and all relevant documentation pertaining to this property should be checked by your legal advisor before exchanging contracts.

Lichfield

Located just north of Birmingham, Lichfield is a charming and historic Cathedral City known for its unique blend of heritage and contemporary living. With excellent transport links via both Lichfield City and Lichfield Trent Valley stations, commuting is effortless.

The city boasts an array of independent boutiques, bars, and restaurants, including the acclaimed Michelin-starred 'Upstairs by Tom Shepherd'. Lichfield also offers an impressive choice of primary and secondary schools, as well as a university campus, making it ideal for families, professionals, and investors alike.

Disclaimer and AML checks

MONEY LAUNDERING REGULATIONS

Should a purchaser(s) have an offer accepted on a property marketed by Jayman, they will need to undertake an identification check and asked to provide information on the source and proof of funds. This is done to meet our obligation under Anti Money Laundering Regulations (AML) and is a legal requirement. We use a specialist third party service together with an in-house compliance team to verify your information. The intending purchaser(s) will be asked to pay a non-refundable compliance fee of £30.00 inc. VAT per buyer for these checks and will be required to be paid in advance when an offer is agreed and prior to a sales memorandum being issued.

- 1: These particulars do not constitute part or all of an offer or contract.
- 2: The measurements indicated are supplied for guidance only and as such must be considered incorrect.
- 3: Potential buyers are advised to recheck the measurements before committing to any expense.
- 4: Jayman has not tested any apparatus, equipment, fixtures, fittings or services and it is the buyers interests to check the working condition of any appliances.
- 5: Jayman has not sought to verify the legal title of the property, and the buyers must obtain verification from their solicitor.

Looking to sell your home?

Our dedicated team is here to make the process smooth, stress-free, and successful.

We pride ourselves on exceptional customer service, guiding you every step of the way with clear communication, expert advice, and a personalized approach tailored to your needs.

Our top priority is to help you achieve the highest possible price for your property, using strategic marketing, local market expertise, and skilled negotiation. Trust us to deliver results with care, professionalism, and your best interests at heart. For a free valuation please contact us.



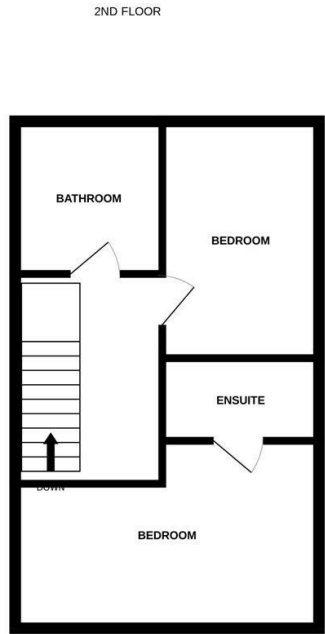
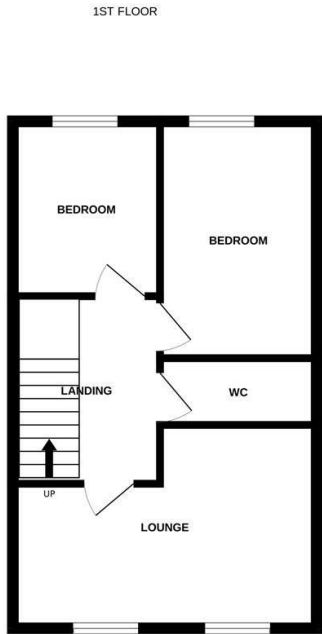
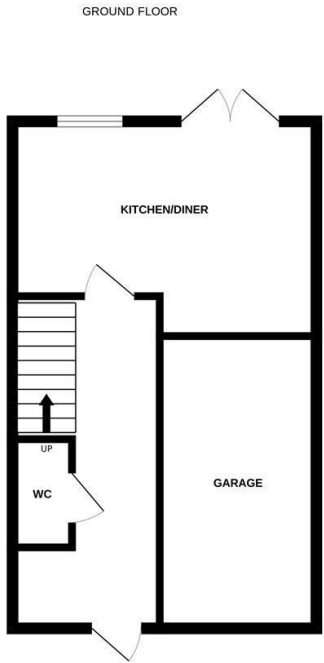

Whilst every attempt has been made to ensure the accuracy of the floorplan contained here, measurements of doors, windows, rooms and any other items are approximate and no responsibility is taken for any error, omission or mis-statement. This plan is for illustrative purposes only and should be used as such by any prospective purchaser. The services, systems and appliances shown have not been tested and no guarantee as to their operability or efficiency can be given.
Made with Metropix ©2025

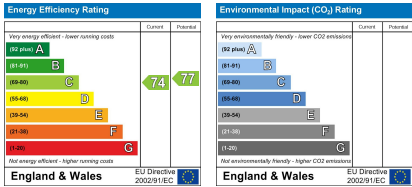
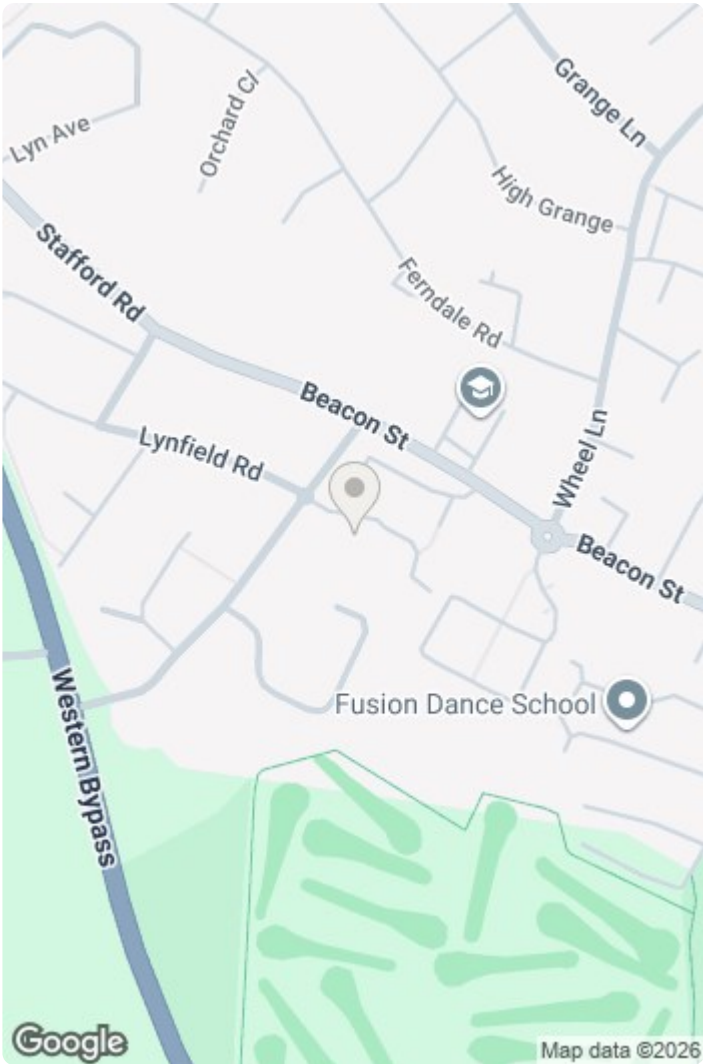

We endeavour to make our sales details accurate and reliable but they should not be relied on as statements or representations of fact and they do not constitute any part of an offer or contract. The seller does not make any representation or give any warranty in relation to the property and we have no authority to do so on behalf of the seller. Services, fittings and equipment referred to in the sales details have not been tested (unless otherwise stated) and no warranty can be given as to their condition. We would strongly recommend that all information, which we provide, about the property is verified by yourself or your advisers.

